

GROUND FLOOR  
382 sq.ft. (35.5 sq.m.) approx.

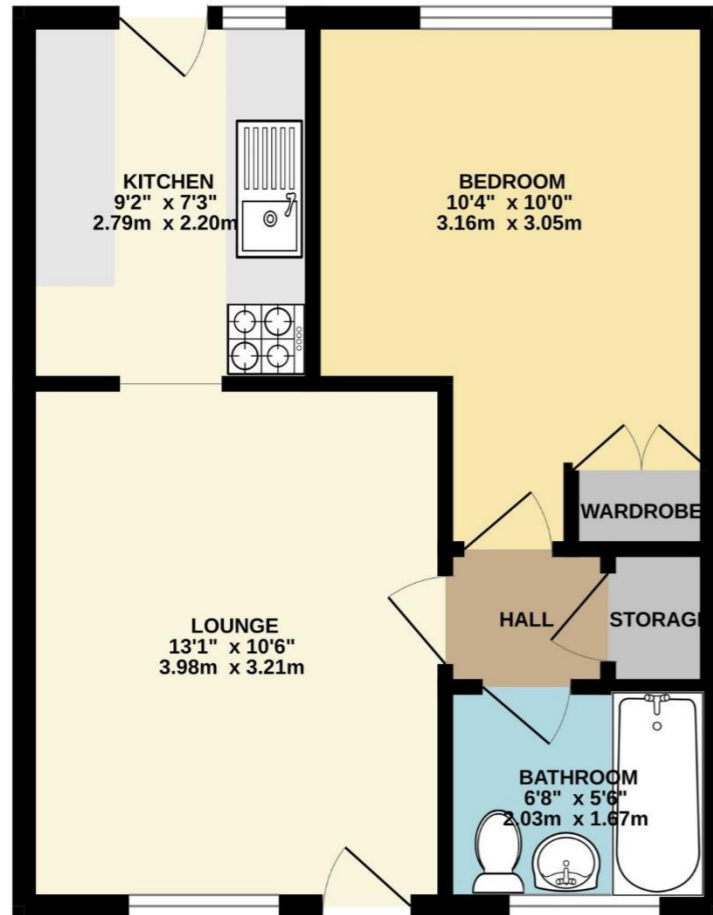

TOTAL FLOOR AREA : 382 sq.ft. (35.5 sq.m.) approx.

Whilst every attempt has been made to ensure the accuracy of the floorplan contained here, measurements of doors, windows, rooms and any other items are approximate and no responsibility is taken for any error, omission or mis-statement. This plan is for illustrative purposes only and should be used as such by any prospective purchaser. The services, systems and appliances shown have not been tested and no guarantee as to their operability or efficiency can be given.  
Made with Metropix ©2023

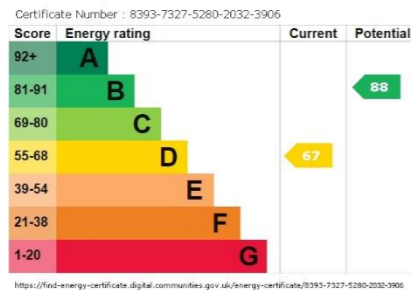

Image Not Available

Image Not Available

## Walnut Tree Drive

Sittingbourne, Sittingbourne, Kent, ME10 1JZ



Image Not Available

Family Homes, 25a West Street,  
Sittingbourne, Kent, ME10 1AL  
01795 473434  
sales@familyhomes.co.uk

Image Not Available

Offers in the region of  
**Offers in region of £165**

Image Not Available



# Walnut Tree Drive

Sittingbourne, Sittingbourne, Kent, ME10 1JZ

## Description

FREEHOLD, CLOSE TO LOCAL BUS ROUTE, SHOPS NEARBY, CHAIN FREE, WELL KEPT SOUTH FACING GARDEN, PRIVATE COMMUNITY WITH JUST 6 BUNGALOWS, OVER 50'S ONLY!

This property is a freehold 1 bedroom bungalow specifically designed to cater to the needs and preferences of individuals over the age of 50. It offers a comfortable and convenient living space, with features and amenities that are tailored to enhance the lifestyle of older adults.

The bungalow is situated in a peaceful and well-maintained residential area, providing a serene environment for its residents. The property boasts a single-story layout, ensuring easy accessibility and eliminating the need for stairs or elevators. This makes it an ideal choice for individuals with mobility concerns or those who prefer a more manageable living space.

Upon entering the bungalow, you will find a spacious and welcoming living room that serves as the central hub of the home. The room is designed to maximize natural light, creating a bright and airy atmosphere. It provides ample space for relaxation, entertainment, and socializing with friends and family.

Adjacent to the living room is a fully equipped kitchen, complete with sufficient storage space. The kitchen has direct access to the rear garden and is a comfortable size for the type of property.

The bungalow features a generously sized bedroom that is designed to accommodate a double bed and additional furniture, providing ample storage options. It also includes large windows that allow natural light to flood in, creating a soothing ambiance.

The bathroom in this property is mostly tiled with 3 piece white site including a shower over bath.

Furthermore, the bungalow includes additional features such as a private garden and patio area where you can enjoy outdoor activities or simply relax amidst nature. This outdoor space provides an opportunity for gardening, hosting small gatherings, or enjoying a cup of tea while basking in the fresh air.

## Room Sizes

